



Two Conductor Solderless  
Lugs

TYPE: A2B2/A2B4



**'PosiGrip'**

90°C RATING (486B LISTED)  
**Patented**

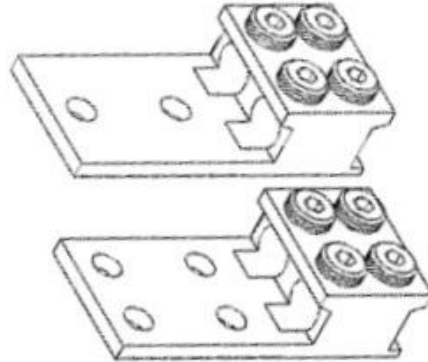

- The unique ridges formed on the bottom of the contact surface are designed to provide contact points for an electrically secure joint of the lowest resistance for current flow.
- The screws used to clamp the conductors are designed to extend beyond the barrel sides of the conductor to allow a better, more secure compression of the conductor. This design spreads the conductor strands to help dissipate heat, and improve its pullout safety features and capabilities.
- The design of the wire way provides optimum transfer of current, creating a straight-line flow through the connector for the least possible path of electrical resistance. A positive wire stop is also provided.

Catalog Number	Fig. No.	Screw Type	Cond. Range AWG	Dimensions, Inches					
				H	W	L	G	D*	T
A2B2-350	1	.31H	350 - 6	1.18	2.9	5.37	0.63	0.56	0.25
A2B2-500	1	.38H	500 - 4	1.56	2.4	5.62	0.63	0.56	0.38
A2B2-600	1	.38H	600 - 2	1.56	2.74	5.62	0.63	0.56	0.38
A2B2-750	1	.38H	750 - 300	1.94	3.5	6.18	0.63	0.56	0.44
A2B2-1000	1	.50H	1000 - 500	1.94	3.5	6.18	0.63	0.56	0.44
A2B4-750	2	.38H	750 - 300	1.94	3.5	6.18	0.63	0.56	0.44
A2B4-1000	2	.50H	1000 - 500	1.94	3.5	6.18	0.63	0.56	0.44

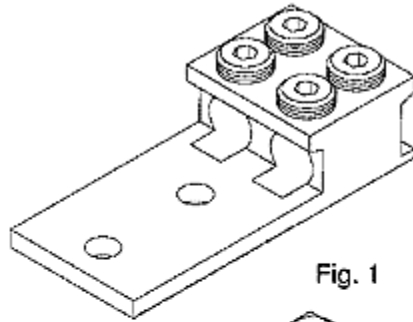

Fig. 1

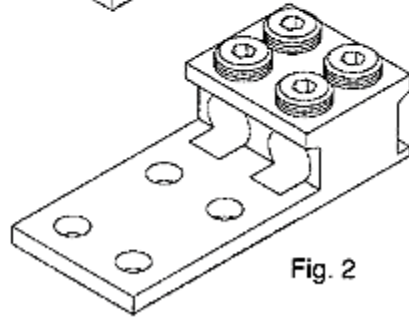
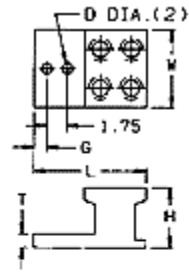
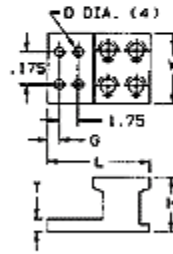

Fig. 2





4300 E. Miraloma Ave. • Anaheim, CA 92807 • Tel. 714.854.1715 Fax 714.854.1716  
[www.cf1.com](http://www.cf1.com)

