



## Cut Threaded Foundation Bolts

### Commonly Stocked Anchor Bolts and J Bolts

#### Anchor Bolts With Nuts

SIZE	LENGTH
5/8-11	12
5/8-11	16
5/8-11	20
5/8-11	24
3/4-10	6
3/4-10	8
3/4-10	10
3/4-10	12
3/4-10	14
3/4-10	16
3/4-10	18
3/4-10	20
3/4-10	24
7/8-9	6
7/8-9	8
7/8-9	10
7/8-9	12
7/8-9	14
7/8-9	16
7/8-9	18
1-8	10
1-8	12
1-8	14
1-8	16
1-8	18
1-8	24

#### J-BOLTS

SIZE	LENGTH
1-8	21
1-8	37
1-8	42
1 1/4-7	30
1 1/4-7	37
1 1/4-7	42

**For Special dimentions Send us your requirements.**

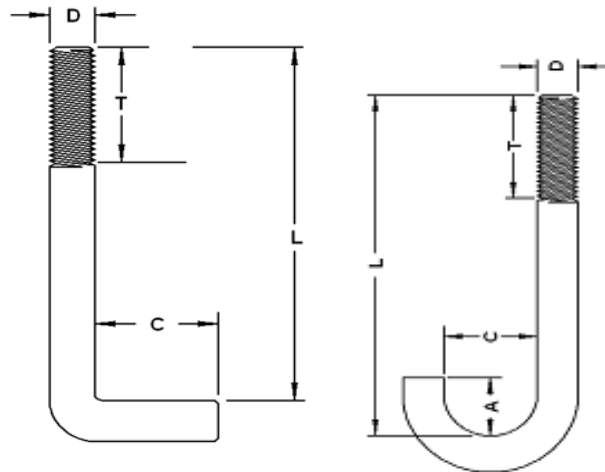

**Dimensions**  
D x L x C x T